



**Bobcat®**

**331E**



**IR Bobcat**



# 331E

|  |                               |         |
|--|-------------------------------|---------|
| <b>Operating weight</b>                      | Canopy                        | Cab     |
| - with rubber tracks                         | 3519 kg                       | 3638 kg |
| - with steel tracks                          | 3591 kg                       | 3710 kg |
| <b>Travel speed</b>                          | 0 - 2.1 km/h and 0 - 5.6 km/h |         |
| <b>Engine</b>                                | 29.9 kW (40 HP)               |         |
| <b>Breakout force</b> (over bucket cylinder) | 3114 daN                      |         |
| <b>Transmission Drawbar Pull</b>             | 3158 daN                      |         |
| <b>Maximum depth</b>                         | 3914 mm                       |         |



## GENERAL INFORMATION

|                     |   |         |
|---------------------|---|---------|
| Operating weight    | canopy  | cab     |
| -with rubber tracks | 3519 kg   | 3638 kg |
| -with steel tracks  | 3591 kg   | 3710 kg |
| Travel speed        | 0 - 2.1 / 0 - 5.6 km/h  |         |
| Controls:           |   |         |
| Vehicle             | Two hand levers / foot pedals for control of speed and direction  |         |
| Excavator function  | Two joystick levers control dipperstick, bucket, boom and slew.<br>Hand lever controls blade. Right foot control for boom offset. |         |



## ENGINE

|                             |                                 |  |
|-----------------------------|---------------------------------|--|
| Make                        | Kubota                          |  |
| Model                       | V 2203 EB                       |  |
| Fuel                        | Diesel                          |  |
| Power (ISO 9249)            | 29.9 kW (40 HP) @ 2400 RPM      |  |
| Displacement                | 2.196 cc                        |  |
| Maximum torque (DIN 6270 B) | 139 Nm @ 1600 RPM               |  |
| Number of cylinders         | 4                               |  |
| Bore x stroke               | 87 x 92.4 mm                    |  |
| Cooling system              | Water                           |  |
| Starter                     | 12 Volt, 2.0 kW reduction drive |  |
| Alternator                  | 12 Volt, 90 Amp.                |  |



## SLEW SYSTEM

|             |   |  |
|-------------|---|--|
| Slew drive  | Orbit motor connected to a planetary drive                                      |  |
| Slew circle | Single row shear type ball bearings with internal gear built into swing circle. |  |
| Slew speed  | 9.2 RPM   |  |
| Boom swing  |   |  |
| - left      | 90°   |  |
| - right     | 50°   |  |



## BREAKOUT FORCE (ISO)

|  |          |
|--|----------|
| Over dipperstick cylinder (w/ arm retracted) | 1879 daN |
| Over dipperstick cylinder (w/ arm extended)  | 1108 daN |
| Over bucket cylinder                         | 3114 daN |



## HYDRAULIC SYSTEM

|                       |   |  |
|-----------------------|---|--|
| Pump type             | Dual outlet variable displacement pump with gear pump |  |
| Capacity              | 2 x 28.8 l/min + 1 x 33.3 l/min                       |  |
| Auxiliary flow        | 62.1 l/min at 2200 RPM                                |  |
| System relief setting | 17235 kPa   |  |
| Control valve         | 10 spools, parallel and serial type, open centre      |  |



## TRANSMISSION

|              |  |  |
|--------------|--|--|
| Final drive  | Each track is independently driven by axial piston motor |  |
| Gradeability | 58 % / 30°   |  |
| Drawbar Pull | 3158 daN   |  |



## BRAKES

|        |                                      |  |
|--------|--------------------------------------|--|
| Travel | Hydraulic lock on motor              |  |
| Slew   | Hydraulic lock on motor and pin lock |  |



## UNDERCARRIAGE

|                               |               |               |
|-------------------------------|---------------|---------------|
| Width of rubber (steel) track | 320 mm        |               |
| Number of track rollers       | 4 each side   |               |
| Ground pressure               | Rubber/Canopy | Rubber/Cabine |
|                               | 31.6 kPa      | 32.7 kPa      |



## CAPACITIES

|                           |        |
|---------------------------|--------|
| Fuel tank                 | 53.3 l |
| Cooling system            | 17.0 l |
| Engine oil & filter       | 7.1 l  |
| Hydraulic tank            | 29.5 l |
| Hydraulic system capacity | 44.0 l |

## WORKING RANGE

All dimensions are in mm.

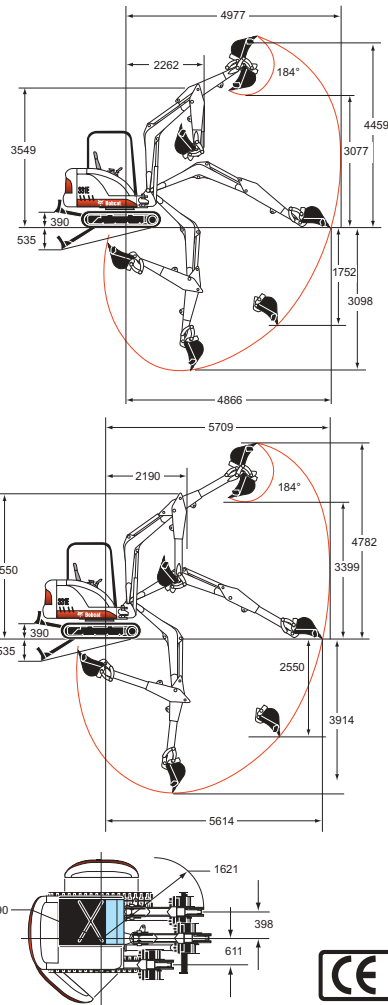

## DIMENSIONS

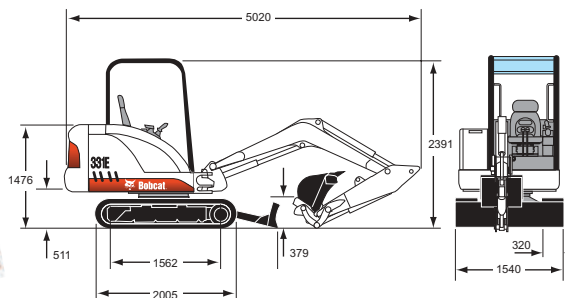

Where applicable, specifications conform to SAE standards. Specifications are subject to change without notice. Pictures of Bobcat min excavators may show other than standard equipment.



**BOBCAT EUROPE**

J. Huysmanslaan, 59 - B - 1651 LOT Belgium  
 ☎ +32 (0)2 371 68 11 - Fax +32 (0)2 371 69 59